

## CHAPTER 12

### SOLUTIONS, SYRUPS, SUSPENSIONS AND EMULSIONS

---

*Ms. Ramandeep Kaur*

*Assistant Professor, Pharmacy Academy, Faculty of Pharmacy, IFTM  
University, Moradabad*

---

#### **12.1 Introduction**

Liquid dosage forms are among the most widely used pharmaceutical preparations because they offer versatility in administration and flexibility in dosing. They are especially valuable in pediatric, geriatric, and critically ill patients who may be unable to swallow solid dosage forms. In many cases, drugs formulated as liquids exhibit a faster onset of action because the drug is already dissolved or finely dispersed, eliminating the need for disintegration and dissolution steps required in tablets or capsules.

Despite their advantages, liquid dosage forms present formulation challenges. They are generally less stable than solid forms due to increased molecular mobility, which accelerates chemical degradation reactions such as hydrolysis and oxidation. They are also more prone to microbial contamination and therefore require preservatives and strict manufacturing controls. Additionally, maintaining uniformity and preventing physical instability such as sedimentation or phase separation is critical.

Solutions, syrups, suspensions, and emulsions represent the major categories of pharmaceutical liquid dosage forms. Each has distinct physicochemical characteristics and formulation considerations. A comprehensive understanding of their principles ensures the development of stable, effective, and patient-friendly products.

#### **12.2 Pharmaceutical Solutions**

##### **12.2.1 Definition and Characteristics**

A pharmaceutical solution is a homogeneous liquid system in which one or more solutes are molecularly dispersed in a suitable solvent. Because the drug exists at the molecular level, solutions provide a uniform distribution of the active ingredient throughout the preparation. This ensures accurate dosing without the need for shaking before use.

Solutions are thermodynamically stable systems. Unlike suspensions or emulsions, they do not exhibit phase separation or sedimentation under normal

storage conditions. The clarity of solutions makes them suitable for ophthalmic, oral, and parenteral administration, where particulate matter must be avoided. The rate of drug absorption from solutions is typically faster compared to solid dosage forms because the drug is already dissolved. However, stability issues such as chemical degradation, precipitation due to pH changes, and microbial growth must be carefully managed.

### 12.2.2 Components of Solutions

A pharmaceutical solution consists primarily of a solvent and a solute. The solvent must be pharmacologically inert, safe, and compatible with the drug. Water is the most common solvent due to its safety and availability. For drugs with limited water solubility, mixed solvent systems containing alcohol, glycerin, or propylene glycol are used.

Excipients are incorporated to enhance stability and palatability. Buffers are added to maintain pH within a range that ensures drug stability and solubility. Antioxidants such as ascorbic acid or sodium metabisulfite may be included to prevent oxidative degradation. Chelating agents bind trace metals that catalyze degradation reactions.

Preservatives are essential in multi-dose preparations to prevent microbial contamination. Flavoring agents and sweeteners improve patient acceptability, especially in oral solutions.

### 12.2.3 Preparation of Solutions

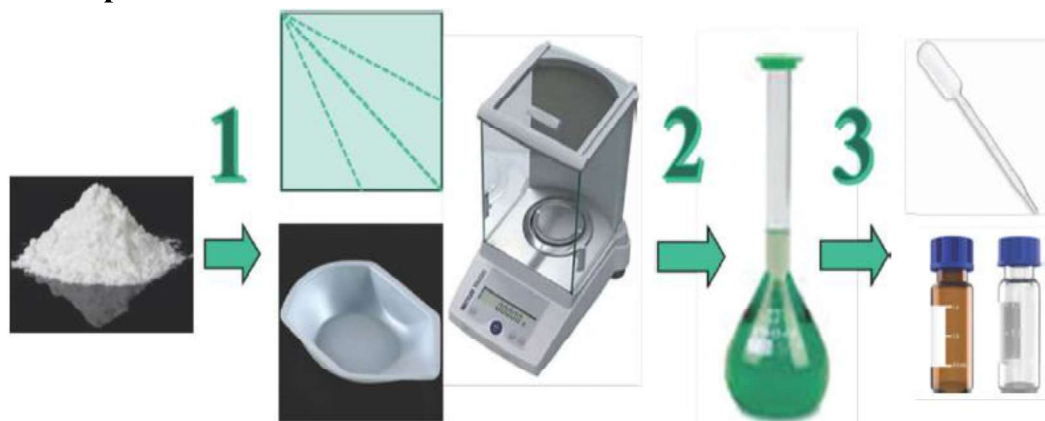

The preparation of solutions involves dissolving the drug in a suitable solvent with continuous stirring to ensure complete solubilization. Gentle heating may be applied to increase solubility if the drug is heat-stable. The order of addition of ingredients is important to prevent precipitation or degradation.

After dissolution, the solution is filtered to remove undissolved particles and ensure clarity. The final volume is adjusted using a calibrated volumetric flask to ensure accurate concentration. Quality control tests such as pH measurement, clarity assessment, and assay determination are performed before packaging.

#### **12.2.4 Advantages and Disadvantages of Solutions**

Solutions provide a rapid therapeutic response because the drug is readily available for absorption. They ensure uniform drug distribution and ease of swallowing. They are particularly useful for drugs requiring flexible dosing adjustments.

However, solutions are more susceptible to chemical degradation and microbial contamination compared to solid forms. They often require preservatives and protective packaging. Additionally, bulky packaging and shorter shelf life may limit convenience.

### **12.3 Syrups**

#### **12.3.1 Definition and Composition**

A syrup is a concentrated, viscous aqueous preparation containing a high percentage of sugar, usually sucrose. The high sugar concentration imparts sweetness and viscosity, making syrups particularly suitable for pediatric formulations.

Sucrose not only provides sweetness but also acts as a preservative by creating high osmotic pressure that inhibits microbial growth. In addition to sucrose, syrups may contain medicinal agents, flavoring substances, coloring agents, and stabilizers.

Syrups can be classified as simple syrups, which contain only sugar and water, and medicated syrups, which include active pharmaceutical ingredients. Sugar-free syrups are formulated for diabetic patients using alternative sweeteners and require added preservatives.

#### **12.3.2 Types of Syrups**

Medicated syrups are used to deliver drugs such as cough suppressants, antihistamines, and vitamins. Non-medicated syrups serve as vehicles in compounding and mask unpleasant tastes.



Herbal syrups are also common and may contain plant extracts dissolved in a syrup base. Sugar-free syrups utilize sweetening agents such as sorbitol, glycerin, or artificial sweeteners.

### **12.3.3 Preparation of Syrups**

Syrups are prepared either by heating or by agitation without heat. The hot process accelerates the dissolution of sucrose but may cause inversion of sucrose into glucose and fructose if overheated. The cold process avoids inversion but requires a longer mixing time.

After preparing the syrup base, the medicinal ingredient is dissolved separately and incorporated with constant stirring. Filtration ensures clarity and uniformity. Care must be taken to avoid crystallization during storage.

### **12.3.4 Advantages and Limitations**

Syrups improve taste and patient compliance, especially in children. Their viscosity provides soothing effects for throat medications. However, high sugar content may not be suitable for diabetic patients. Crystallization or microbial growth may occur if improperly formulated.

## **12.4 Suspensions**

### **12.4.1 Definition and Characteristics**

A suspension is a heterogeneous system containing finely divided insoluble drug particles dispersed uniformly in a liquid medium. Unlike solutions, suspensions require shaking before use to ensure uniform distribution.

Suspensions are particularly useful for drugs that are insoluble or unstable in solution form. They allow higher drug concentration and may provide improved chemical stability.

Physical stability is a major concern. Suspensions must be designed to prevent rapid sedimentation and the formation of a hard cake that cannot be redispersed.

### **12.4.2 Components of Suspensions**

Suspensions contain the dispersed phase, dispersion medium, suspending agents, wetting agents, and preservatives. Suspending agents increase viscosity and slow sedimentation. Wetting agents reduce surface tension and promote uniform dispersion of hydrophobic particles.

Flocculating agents may be added to form loose aggregates that settle rapidly but redisperse easily. Preservatives prevent microbial growth in aqueous suspensions.

### 12.4.3 Preparation of Suspensions

Preparation involves particle size reduction through milling to enhance uniformity. The drug is wetted with a suitable wetting agent and gradually incorporated into the vehicle under continuous stirring.

Homogenization ensures the uniform distribution of particles. The final product should exhibit an acceptable sedimentation rate and easy redispersibility.

### 12.4.4 Evaluation of Suspensions

Evaluation includes measurement of sedimentation volume, viscosity, redispersibility, and particle size distribution. An ideal suspension should settle slowly and redisperse upon gentle shaking without forming a compact sediment. Stability studies assess changes in physical characteristics over time.

### 12.4.5 Advantages and Disadvantages

Suspensions enable the administration of poorly soluble drugs and provide flexibility in dosing. They may improve stability compared to solutions. However, they require shaking and may show dose variability if not properly dispersed.

## 12.5 Emulsions

### 12.5.1 Definition and Types

An emulsion is a biphasic system consisting of two immiscible liquids, one dispersed in the other in the form of droplets. Emulsions are inherently unstable and require emulsifying agents for stabilization.

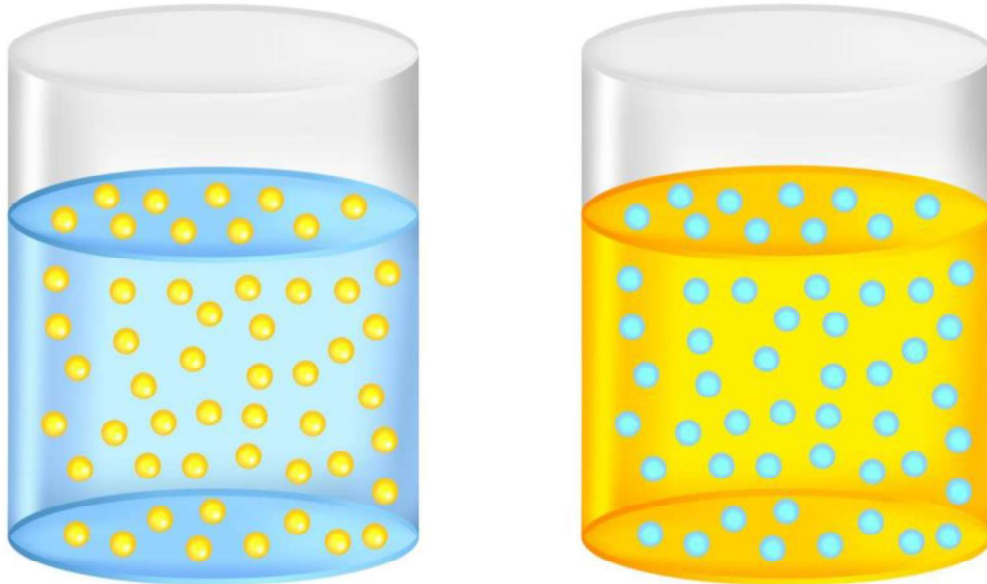

Oil-in-water emulsions have oil droplets dispersed in water and are commonly used for oral and topical applications. Water-in-oil emulsions have water droplets dispersed in oil and are often used for topical preparations.

### **12.5.2 Components of Emulsions**

Emulsions consist of an oil phase, an aqueous phase, an emulsifying agent, and sometimes stabilizers. Emulsifiers reduce interfacial tension and form protective films around droplets to prevent coalescence.

The selection of an emulsifier depends on the required hydrophilic–lipophilic balance. Stabilizers may increase viscosity and enhance physical stability.

### **12.5.3 Preparation Methods**

Emulsions are prepared by methods such as dry gum, wet gum, and mechanical homogenization. High-speed homogenizers reduce droplet size, improving stability and uniformity.

Proper control of mixing conditions is essential to prevent phase separation.

### **12.5.4 Instability of Emulsions**

Emulsions may undergo creaming, flocculation, coalescence, and phase separation. Creaming involves the upward movement of droplets due to density differences. Coalescence leads to the merging of droplets and eventual separation. Stability can be improved by selecting appropriate emulsifiers, controlling droplet size, and increasing viscosity.

### **12.5.5 Applications and Evaluation**

Emulsions are used for the delivery of oily drugs, topical creams, and parenteral nutrition. Evaluation includes measurement of globule size, viscosity, pH, and stability under storage conditions.

## **12.6 Conclusion**

Solutions, syrups, suspensions, and emulsions represent essential liquid dosage forms in pharmaceutical practice. Each system has distinct formulation principles and stability challenges. Proper understanding of their physicochemical behavior, preparation techniques, and evaluation methods ensures the development of safe, stable, and effective liquid medicines. These dosage forms continue to play a vital role in modern therapeutics due to their adaptability and patient-friendly characteristics.